

1:1

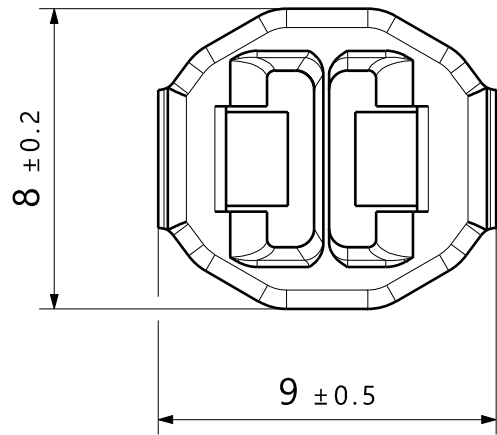
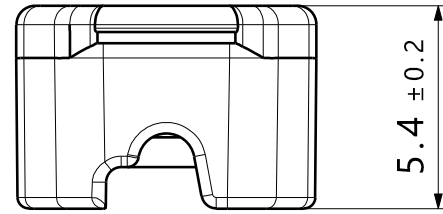
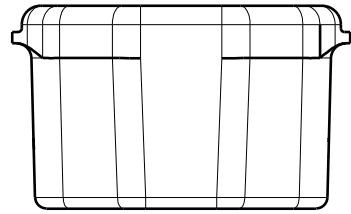

Printed copy for information only/
Ausdruck nur zur Information

5000 Closure from roll magazine

5000 Koepfe von Rollmagazin

- Material: PA6.6 heat- and UV-stabilized
- Material color: black optional nature

- Material: PA6.6 hitze- und UV-stabilisiert
- Material Farbe: schwarz wahlweise natur

The manufacturing-related geometry changes (injection point, ejectors marks, etc.) allowed. Design of the details are left to suppliers discretion.

Durch das Herstellverfahren bedingte Geometrieaenderungen (Anspritzung, Auswerfermarkierungen, etc.) zulaessig. Einzelheiten der Ausfuehrung bleiben dem Hersteller ueberlassen.

Revision Level		Revision Record	
Drawing	State	Part	
01.3	Design Release	01.2	Drawing, material and closure geometry revised
Changed	Date (YYYY/MM/DD)		
Villbrandt	2020/10/21		
Approved	Date (YYYY/MM/DD)		
B. Schiwek	2020/10/21		

Drawing, material and closure geometry revised

All drawing revisions are stored in CAD PDM database

The copyright of this drawing is reserved by HellermannTyton.

Drawn	Date (YYYY/MM/DD)
Mueller	2001/10/16
Approved	Date (YYYY/MM/DD)
Wien	2001/10/16

Title		Scale	
Closure ATS3080		5:1	
Drawing-No		Global Project Number	
14.1560		12-0093	
		Format A3	
		Sheet 1 / 1	

HellermannTyton
www.HellermannTyton.com